

THIS DRAWING IS A CONTROLLED DOCUMENT.

PART NUMBER	REV	FIRST USED
1852298-1	C	122500-1
1852298-2	C	565435-5
7-1852298-7	B	SPARE PARTS KIT

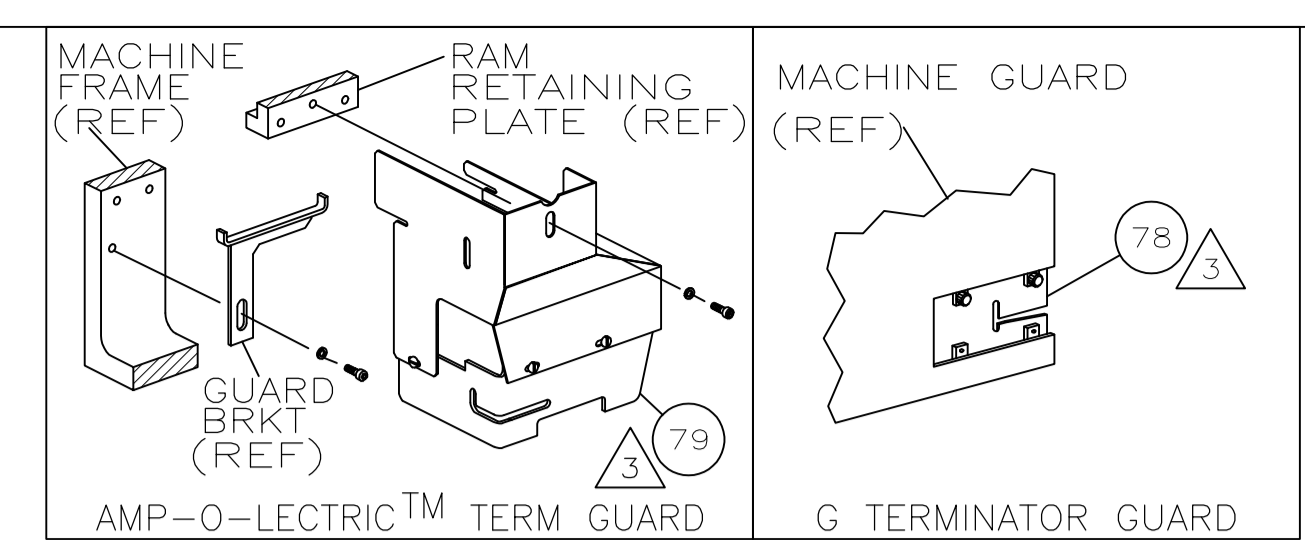

TERMINAL NAME: TERMINAL, SAW TOOTH		AMP TERMINAL - AMP CRIMP SPECS	
TEC PN	-	PAD LTR	CRIMP HEIGHT
62311	-	A	.119±.002 [3.02 ±0.05mm]
		B	NOT
		C	NOT
		D	NOT
		CRIMP	SIZE
		WIRE	.250 [6.35mm]
		INSUL	-
		TYPE	F
		RANGE	17000-17500
WIRE STRIP LENGTH	TERM APPL SPEC	FEED	APPL INSTRUCTION
.385-.425	114-2003	.432	408-8039
		SET UP GAGE	LAYOUT
		458638-1	-

USED ON	
-1	LEADMAKER & BENCH MODEL G AIR FEED
-2	BENCH MODEL K AIR FEED

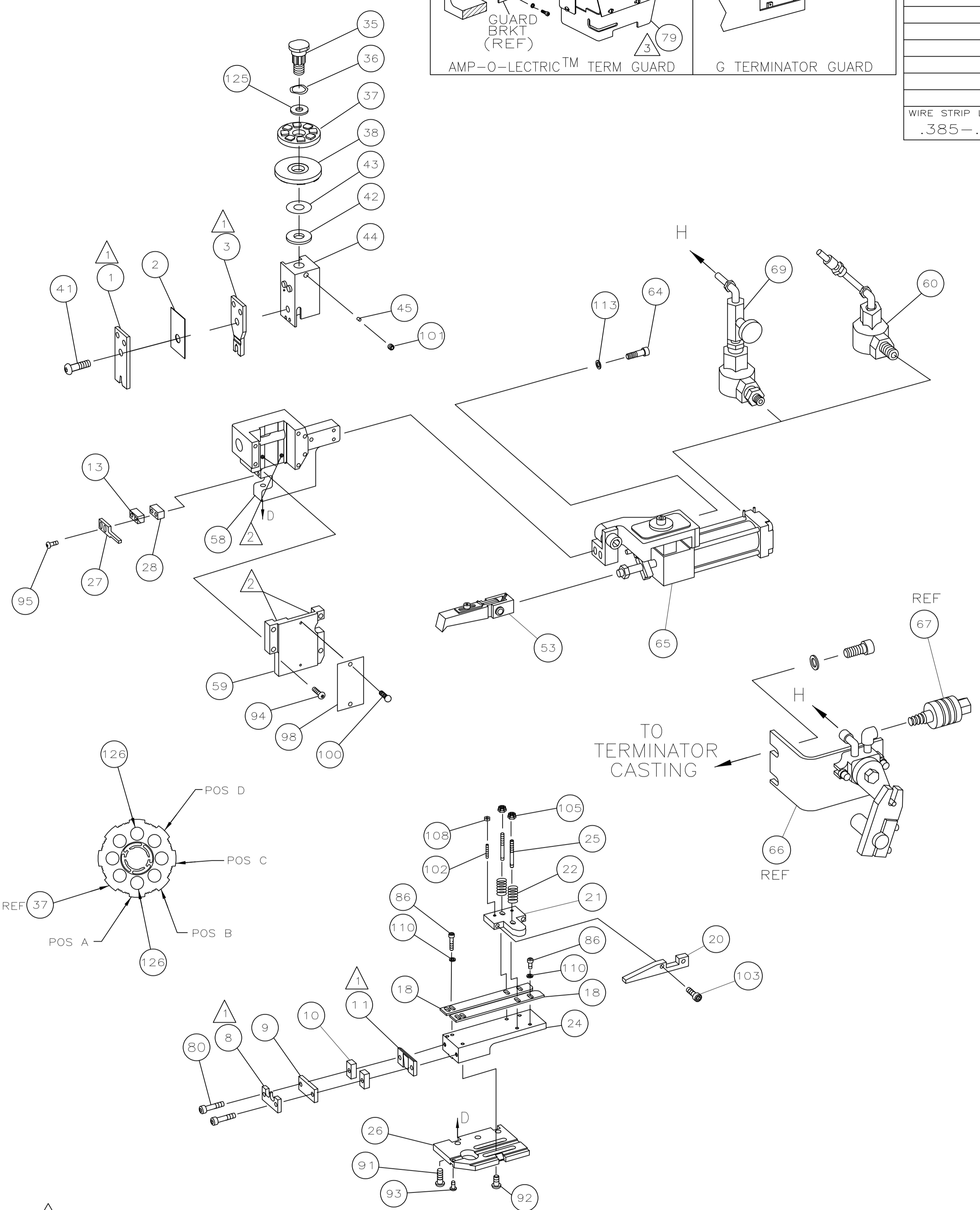

QTY REQD PER ASSY	REF	QTY	PART NO	DESCRIPTION	ITEM NO
-		2	3-354779-4	PIN, WIRE DISC (.3160)A	126
-		1	986950-1	WASHER, FLAT PRECISION	125
-		1	217238-1	GENERAL INSTRUCTION PACKAGE	124
-		1	4088039	EF APPL INST 408-8039	123
-		2	21024-5	WASHER, LOCK(#10)AIR ASSY	113
-		5	21024-4	WASHER, LOCK(NO.8)SHEAR BL	110
-		2	21018-4	NUT, HEX(4-40)DRAG	108
-		2	21022-2	NUT, HEX SL(8-32)DRAG STUD	105
-		2	1-21000-3	SCR, SHC(4-40X.25)DRAG ARM	103
-		2	2-21006-6	SCR, SKT SET(4-40X.62)DRAG	102
-		1	21009-2	SCR, SKT SET(1/4-20X.25 )RAM	101
-		2	21017-2	SCR, DRIVE(#2X.19)ID PLATE	100
-		1	461264-1	PLATE, IDENTIFICATION	99
-		2	8-21002-9	SCR, BHC(8-32X1.00)STRIPPER	96
-		4	2-21002-9	SCR, BHC(10-32X.75)CAP	94
-		1	22733-8	SCR, BHC(8-32X.38 LW)ANVIL	93
-		4	3-21002-3	SCR, BHC(1/4-20X.50)ST GD PL	92
-		3	2-22733-8	SCR, BHC(1/4-20X.62)HSG	91
-		4	2-21000-6	SCR, SHC(8-32X.38)STRIP GUIDE	86
-		2	3-21002-0	SCR, BHC(10-32X.88)SHEAR PL	80
-		REF	455749-1	GUARD ASSY	79
-		REF	679532-1	INSERT, GUARD	78
-77	-2	-1	U/M	PART NO	DESCRIPTION
					ITEM NO

QTY REQD PER ASSY	REF	QTY	PART NO	DESCRIPTION	ITEM NO	
-		1	692655-5	AIR FEED VALVE ASSY	70	
-	REF	-	24042-2	VALVE, SHUT OFF	68	
-	REF	-	692655-6	AIR FEED VALVE ASSY	66	
-	1	1	460277-1	AIR FEED ASSY (1 INCH)	65	
-	2	2	3-21000-9	SCR, SHC(10-32X1.00)AIR ASSY	64	
-					63	
-					62	
-					61	
-	1	1	692655-7	AIR FEED VALVE ASSY	60	
-	1	1	454220-1	CAP, RAM	59	
-	1	1	453736-1	HOUSING	58	
-					57	
-					56	
-					55	
-					54	
-	4	1	460680-2	FEED FINGER ASSY	53	
-					52	
-					51	
-					50	
-					49	
-					48	
-					47	
-					46	
-	1	1	690191-1	PLUG, NYLON	45	
-	1	1	455674-5	RAM	44	
-	1	1	690125-1	WASHER, LAMINATED	43	
-	1	1	690124-7	WASHER, RAM	42	
-	1	1	7-21002-9	BOLT, CRIMPER(5/16-24X1.00)	41	
-					40	
-					39	
-	1	1	690223-2	SPACER, INSULATION DISC	38	
-	1	1	354777-1	DISC ASSEMBLY, WIRE	37	
-	1	1	22480-5	WASHER, SPRING	36	
-	1	1	690212-1	POST, RAM	35	
-					34	
-					33	
-					32	
-					31	
-					30	
-					29	
-	1	1	1-690451-6	SPACER, STRIPPER	28	
-	1	1	690455-1	STRIPPER	27	
-	1	1	459717-1	PLATE, BASE	26	
-	2	2	22354-8	DRAG, STUD	25	
-	1	1	455678-1	PLATE, STRIP GUIDE	24	
-					23	
-	2	2	2-22281-3	SPRING, DRAG	22	
-	1	1	464451-1	ARM, STOCK DRAG	21	
-	1	1	464452-4	DRAG, STOCK	20	
-					19	
-	2	2	1-454204-0	GUIDE, STRIP (FRONT)	18	
-					17	
-					16	
-					15	
-					14	
-					13	
-	1	1	1-690451-3	SPACER, STRIPPER	12	
-					11	
-	1	1	240644-1	PLATE, REAR SHEAR	10	
-	2	2	240645-5	SPACER, HOLD DOWN	9	
-	1	1	690619-6	PLATE RETAINING	8	
-	1	1	459716-5	ANVIL	7	
-					6	
-					5	
-					4	
-					3	
-	1	1	1	2-459722-1	SHEAR BLADE	2
-	1	1	1	455888-1	SPACER, CRIMPER	1
-	1	1	1	1633779-2	CRIMPER, WIRE	1
-77	-2	-1	U/M	PART NO	DESCRIPTION	
					ITEM NO	

- 1 RECOMMENDED SPARE PARTS.
- 2 GREASE LIGHTLY.
- 3 GUARD MUST BE IN PLACE WHEN OPERATING APPLICATOR IN A BENCH MACHINE.
- 4 SEE DRAWING FOR COMPONENTS
- 5 ITEM 78 USED WITH G TERMINATOR ONLY.
- 6 CRIMPING BELOW RECOMMENDED CMA RANGE WILL DAMAGE TOOLING.
- 7 CRIMPING ABOVE RECOMMENDED CMA RANGE MAY EXCEED TERMINATING UNIT'S CAPABILITY CYCLING TERMINATING UNIT WITHOUT A TERMINAL OVER THE ANVIL WILL DAMAGE TOOLING
- 8

LOC A  
DIST 66

ECR-13-014931	23SEP2013	MY	GB	SCALE	A1	DRAWING NO	1852298	SHEET	1 of 1	REV	C
REVISION RECORD		DATE	OWN	APVD	END FEED HDM APPLICATOR		1852298		C		

TE Connectivity

CUSTOMER ACCESSIBLE PRODUCTION DRAWING