

DETAIL A  
SCALE 13:1

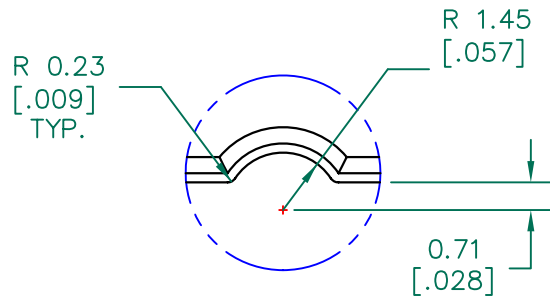

DETAIL B  
SCALE 5:1

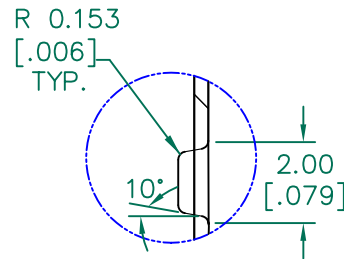

DETAIL C  
SCALE 4.5:1

**UNCONTROLLED  
DOCUMENT**

IMPEDANCE (Z)			
Frequency	25 MHz	100 MHz	300 MHz
Nominal (REF)	100 Ω	280 Ω	590 Ω
Minimum	- Ω	224 Ω	- Ω

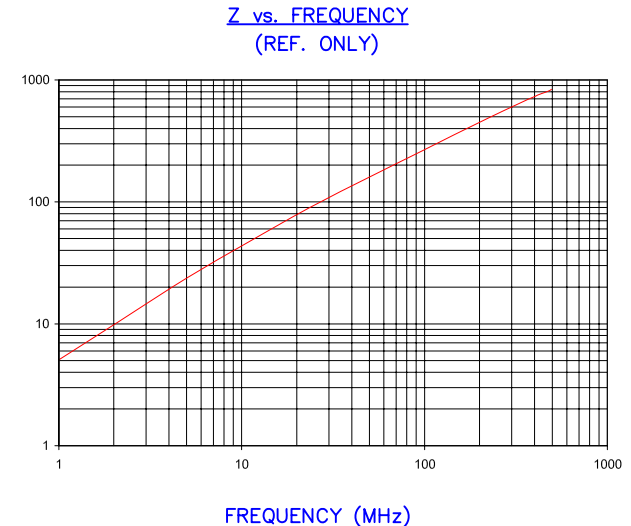

AGILENT E4991A Impedance/Material Analyzer  
HP 16092A-Test Fixture REF 3431

FERRITE CORE DIMENSIONS (SPEC): mm [in.]

A	63.50 [2.500]	+	1.27 [.050]
B	52.07 [2.050]	+	1.02 [.040]
C	28.58 [1.125]	+	0.64 [.025]
D	6.35 [.250]	+	0.25 [.010]
E	0.84 [.033]	+	0.25 [.010]
F	7.62 [.300]	+	0.18 [.007]
G	31.75 [1.250]	+	0.76 [.030]
H	2.74 [.108]	+	0.25 [.010]
J	0.86 [.034]	+	0.25 [.010]

WEIGHT/1000 50.13 kgs 110.53 Lbs

NOTES:

1. ADD ONE METAL CLIP FOR SHIPPING.
2. METAL CLIP SPECIFICATION: ASSE017-2.
3. INCLUDES ONE CORE AND ONE CLIP.
4. PART WEIGHT IS FOR ONE CORE.
5. USE FERRITE CORE STEWARD P/N 28S2001-000.

DIMENSIONS ARE IN mm[INCHES].			
J	CHANG DETALL C	07/09/10	JUN
H	UPDATE COMPANY LOGO REVISE DIMPLE AND DIMENSIONS IN DETAIL C	10/16/08	JRK
G	UPDATE NOTES ADD TEST REF NUMBER	08/11/05	JRK
F	UPDATE FORMAT & Z SPECS REMOVE NOTE 1 ADD Z CURVE	07/09/03	JRK
E	ADD NOTE # 3	01/23/02	JRK
D	UPDATE PRINT FORMAT ADD DETAILS, UPDATE Z SPECS	09/28/01	JRK
C	UPDATE P/N FOR NEW CATALOG	09/27/95	JBE
REV	DESCRIPTION	DATE	INT

This print is the property of Laird Tech. and is loaned in confidence subject to return upon request and with the understanding that no copies shall be made without the written consent of Laird Tech. All rights to design or invention are reserved.



PROJECT/PART NUMBER:	REV	PART TYPE:	DRAWN BY:
28S2001-0M0	J	CNZ SPLIT FERRITE CORE	JBE
DATE:	SCALE:	MATERIAL:	
11/02/94	1.5 : 1	FERRITE	
CAD #	TOOL #		
28S2001-0M0-J	S2001		