

SPRING & BUTTON CONTACTS

- Economical and reliable contacts are ideal for molded cases with self contained battery compartments
- "Solder tab" design for either wire lead or PC mounting
- Unique spring contacts adjust to variations in battery lengths
- Reliable spring contacts assure low contact resistance and a dependable connection
- Space saving, economical, excellent mechanical construction

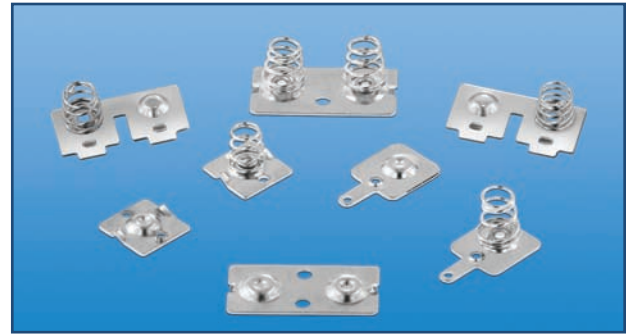

MATERIAL:

Plate: .020 (.51) Steel, Nickel Plate **Spring:** Spring Steel, Nickel Plate

Refer to page 35 for Battery Contact Layout & Mounting Details

"AAA" · "AAAA" · "N" · "12V"



(-) NEGATIVE SPRING

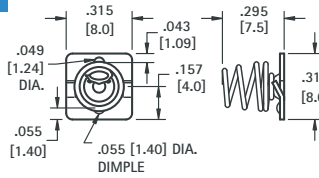

CAT. NO. 5203



(+) POSITIVE BUTTON

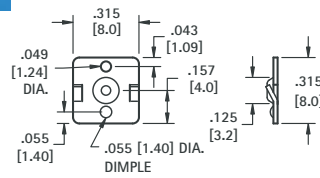

CAT. NO. 5225



DUAL CONTACT (RIGHT)

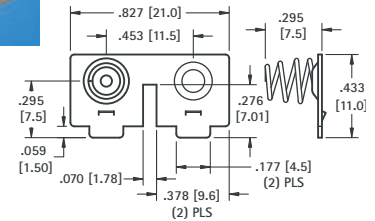

CAT. NO. 5213



(-) NEGATIVE SPRING WITH TAB

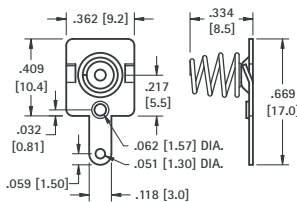

CAT. NO. 5204



(+) POSITIVE BUTTON WITH TAB

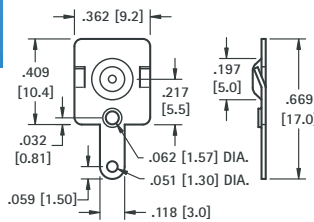

CAT. NO. 5226



DUAL CONTACT (LEFT)

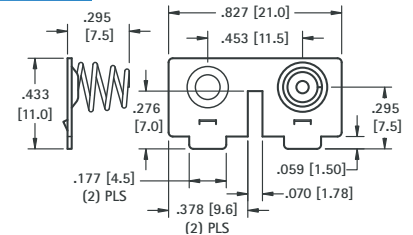

CAT. NO. 5214

"AA" · "CR2" · "A" · 17-19mm



(+) POSITIVE BUTTON

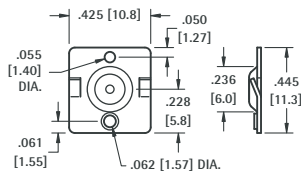

CAT. NO. 5224



(-) NEGATIVE SPRING

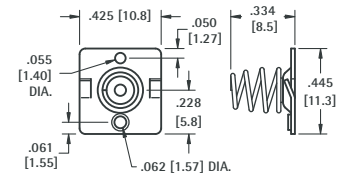

CAT. NO. 5202

"AA"



DUAL BUTTON CONTACT

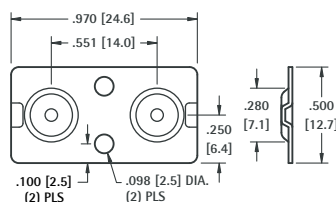

CAT. NO. 5227



DUAL SPRING CONTACT

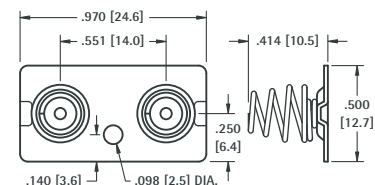

CAT. NO. 5228